

### 1. DEMONAREA CORPULUI DE ILUMINAT

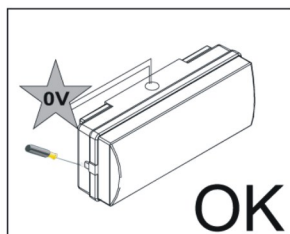

1

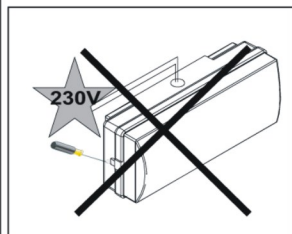
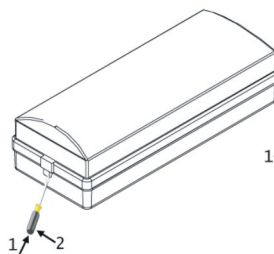

2

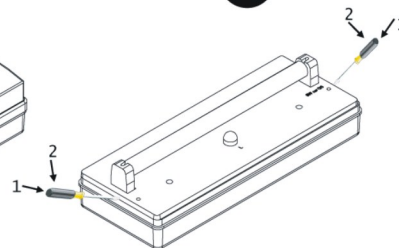

### 2. FIXAREA ÎN PLAFON

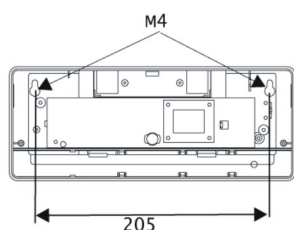

### 2. FIXAREA PE PERETE

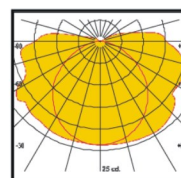
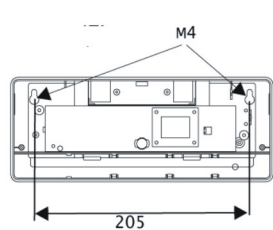

Curbe la comandă

### 3. CONEXIUNE ELECTRICĂ ȘI TEST

#### TEST ZC

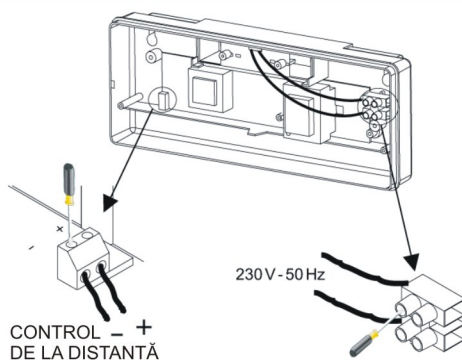
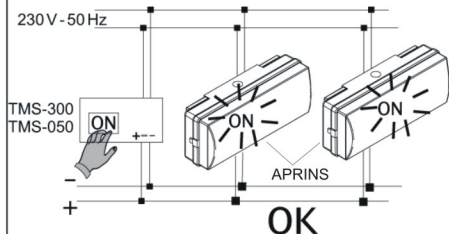

FZS-6031C	35 lm	1 h	
FZS-6051C	45 lm	1 h	
FZS-6061C	65 lm	1 h	
FZS-6101C	70 lm	1 h	
FZS-6111C	100 lm	1 h	
FZS-6161C	125 lm	1 h	
FZS-6251C	180 lm	1 h	
FZS-1401C	330 lm	1 h	
FZS-6052C	45 lm	1 h	
FZS-6102C	70 lm	1 h	
FZS-6162C	125 lm	1 h	
FZS-6252C	180 lm	1 h	
FZS-1402C	330 lm	1 h	

### MARCAREA CORPULUI DE ILUMINAT

**X:** Autonom

**O:** Nepermanent

**B:** Controlabil de la distanță

\***60/120/180:** Autonomia nominală a corpului de iluminat (în minute)

- **DURATA DE ÎNCĂRCARE:** 24 h

- **SCHIMBAREA BATERIILOR:** Bateriile trebuie înlocuite atunci când durata lor nu e aceeași cu autonomia declarată. NOTĂ: Pentru a prelungi viața bateriilor este recomandată descărcarea completă periodică (prin deconectarea alimentării principale) cel puțin o dată la 10 săptămâni.